

ONESOUTH

TRADE & TRYON

SUITE 1720 | 2,997 RSF

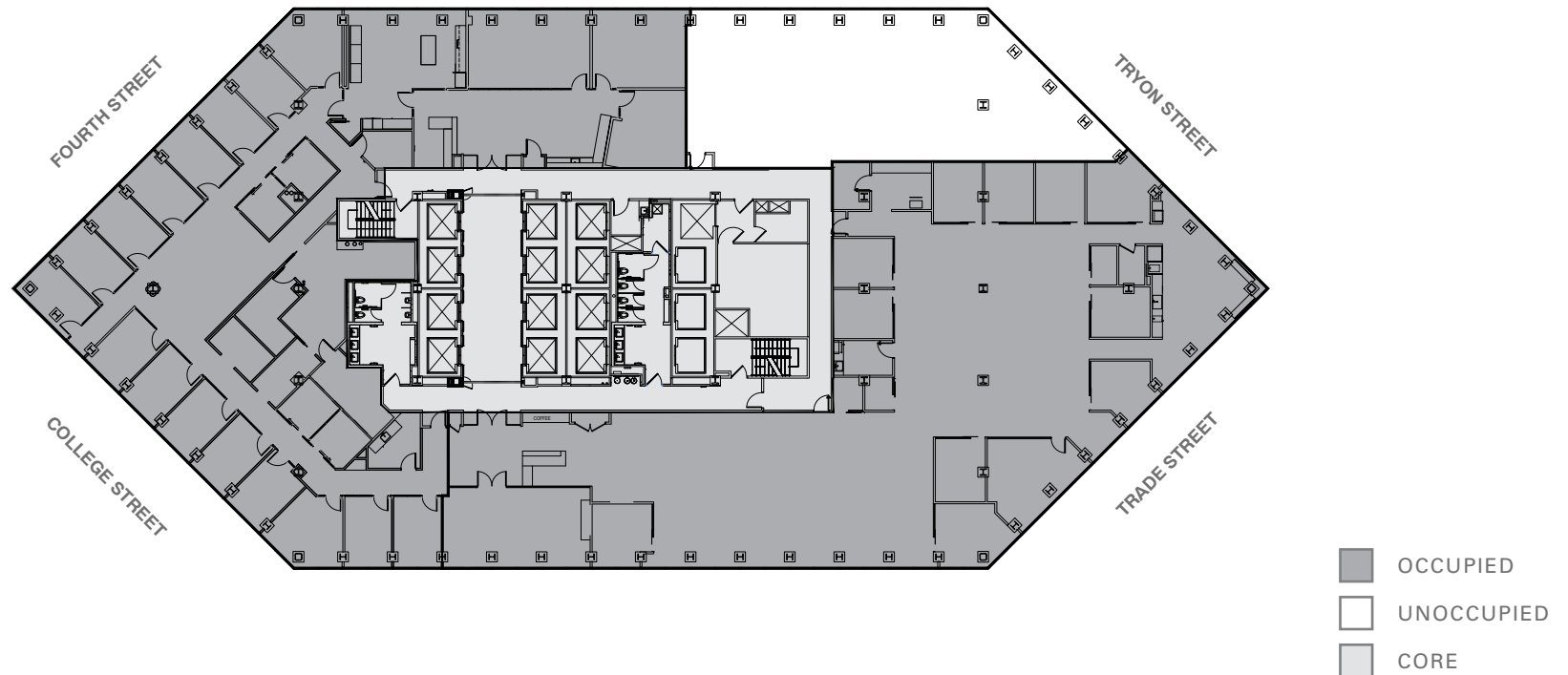

CONTACT

RHEA GREENE | rdg@trinity-partners.com | 704.372.8822

TIM ARNOLD | tarnold@trinity-partners.com | 704.295.0404

JOHN HANNON | jhannon@trinity-partners.com | 704.813.7252

leased by

**TRINITY
PARTNERS**

owned by

**MONARCH
ALTERNATIVE CAPITAL**

Tourmaline

ONESOUTH

TRADE & TRYON

SUITE 1720 | 2,997 RSF

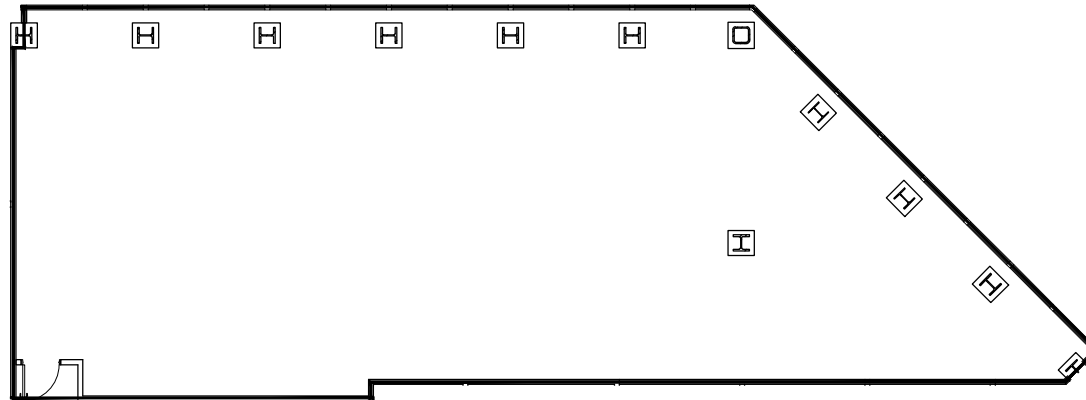

CONTACT

RHEA GREENE | rdg@trinity-partners.com | 704.372.8822

TIM ARNOLD | tarnold@trinity-partners.com | 704.295.0404

JOHN HANNON | jhannon@trinity-partners.com | 704.813.7252

leased by



owned by

